

STEP 1

Assemble the Transaction Counter upside-down.

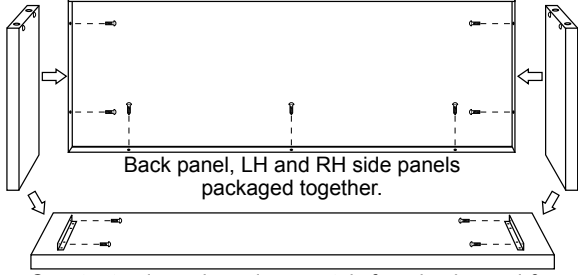

Counter top is packaged separately from back panel & side panels.

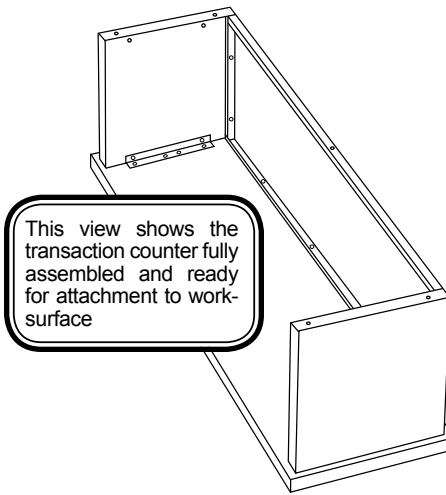

STEP 2

Set assembled Transaction Counter onto work-surface as shown

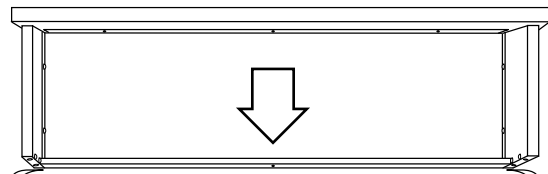
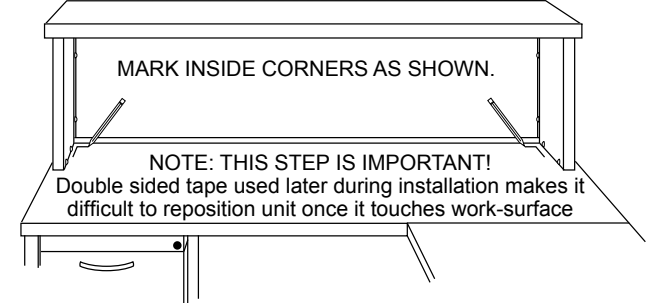

Remove paper tape backing on bottom of LH & RH side panels and lower down onto work surface next to registration marks you made earlier in step 2.

STEP 3

NOTE: Work surface should be free of dust to ensure tape will stick.

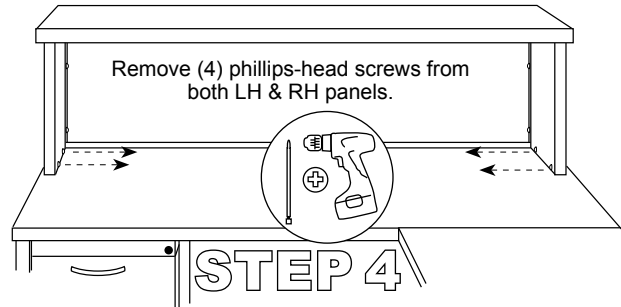

STEP 4

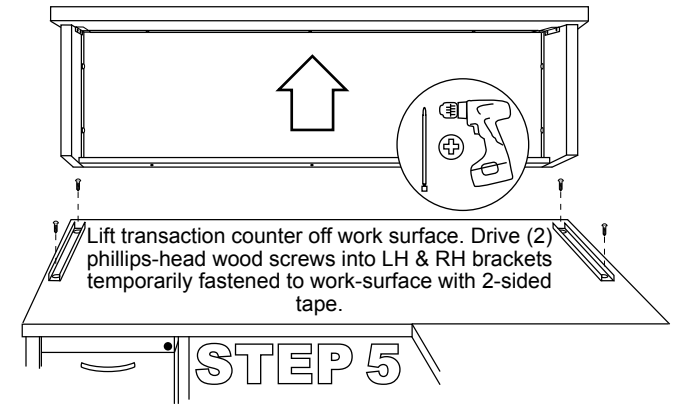

STEP 5

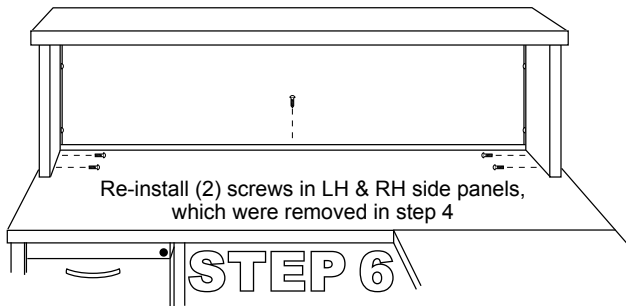

STEP 6

